

COMPTON 1810 S. CALIFORNIA
Santa Fe Ave.



± 46,980 SF FREE-STANDING BUILDING FOR SALE

EXCLUSIVE LISTING AGENTS

DAVID FREITAG
P: 213.270.2235 | M: 310.413.9390
E: dfreitag@daumcre.com
CA License #00855673

BRIAN JORGE
D: 310.538.6702
E: bjorge@daumcre.com
CA License #01947601

JEFF JORGE
D: 310.538.6703
E: jjorge@daumcre.com
CA License #01947947

KRIS COONTZ
D: 213.270.2231 | M: 626.660.5514
E: kcoontz@daumcre.com
CA License #02216169

WWW.THELAININDUSTRIAL.COM

COMMERCIAL REAL ESTATE SERVICES

COMPTON 1810 S. CALIFORNIA
Santa Fe Ave.



About the Property



**Prime Alameda Corridor
Location**



MH Zoning Heavy



Metal Industrial Warehouse



Twelve Miles from Ports



**Excellent Access to Major
Freeways 91, 710, 110, and 405**



Development Opportunity

COMPTON 1810 S. CALIFORNIA
Santa Fe Ave.

Offering Price

Asking Sale Price: \$9,325,000

PSF: \$104.99 Land | \$198.49 BLDG.

Property Highlights



±46,980 Available SF



± 2.04 AC
± 88,819 SF



1952 Year Built



To Be Verified



Metal Construction



16' Clear Height



APN: 7318-004-021



To Be Verified



PROPERTY INFORMATION

1810 S. Santa Fe Ave.

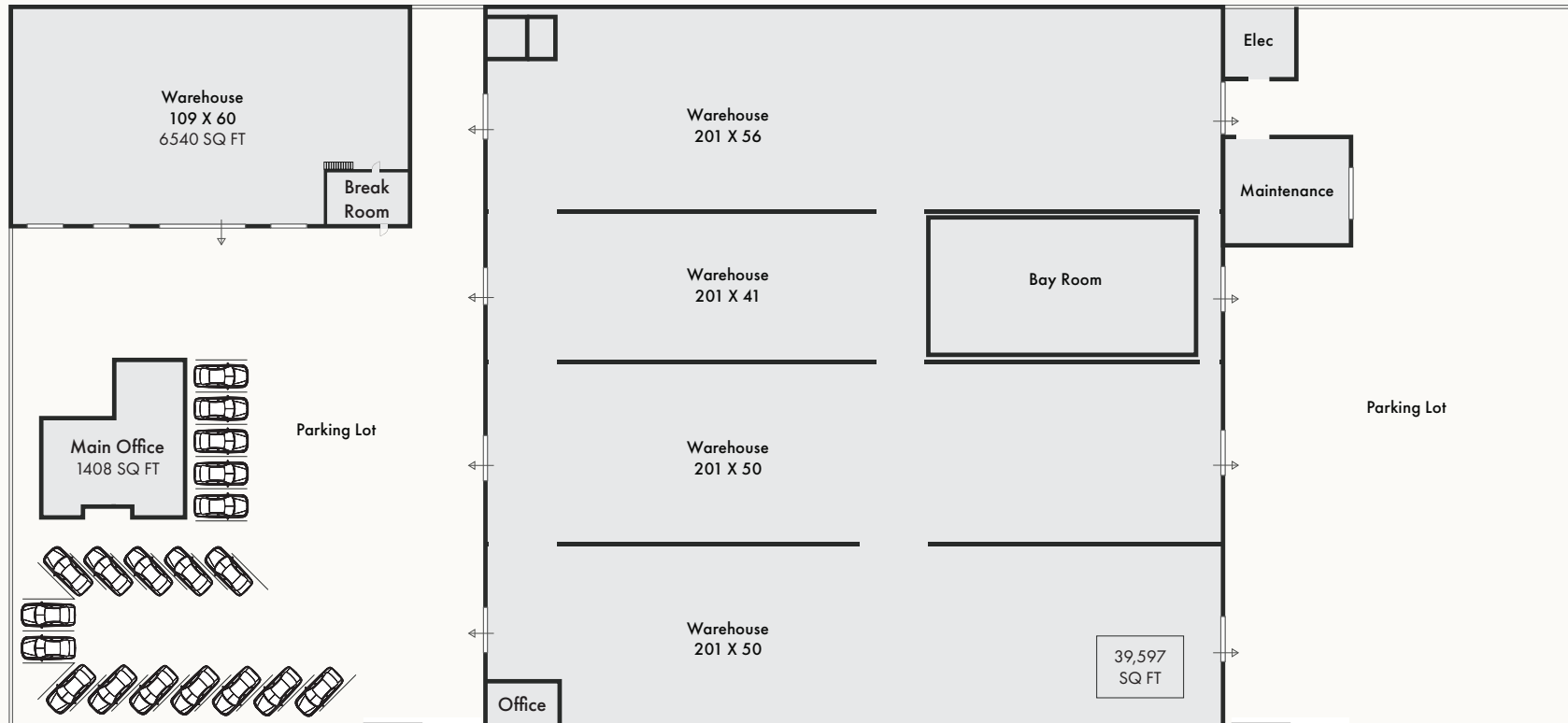

SANTA FE AVE.

NOT TO SCALE*

COMPTON | CALIFORNIA

AMENITIES + TRAFFIC COUNT

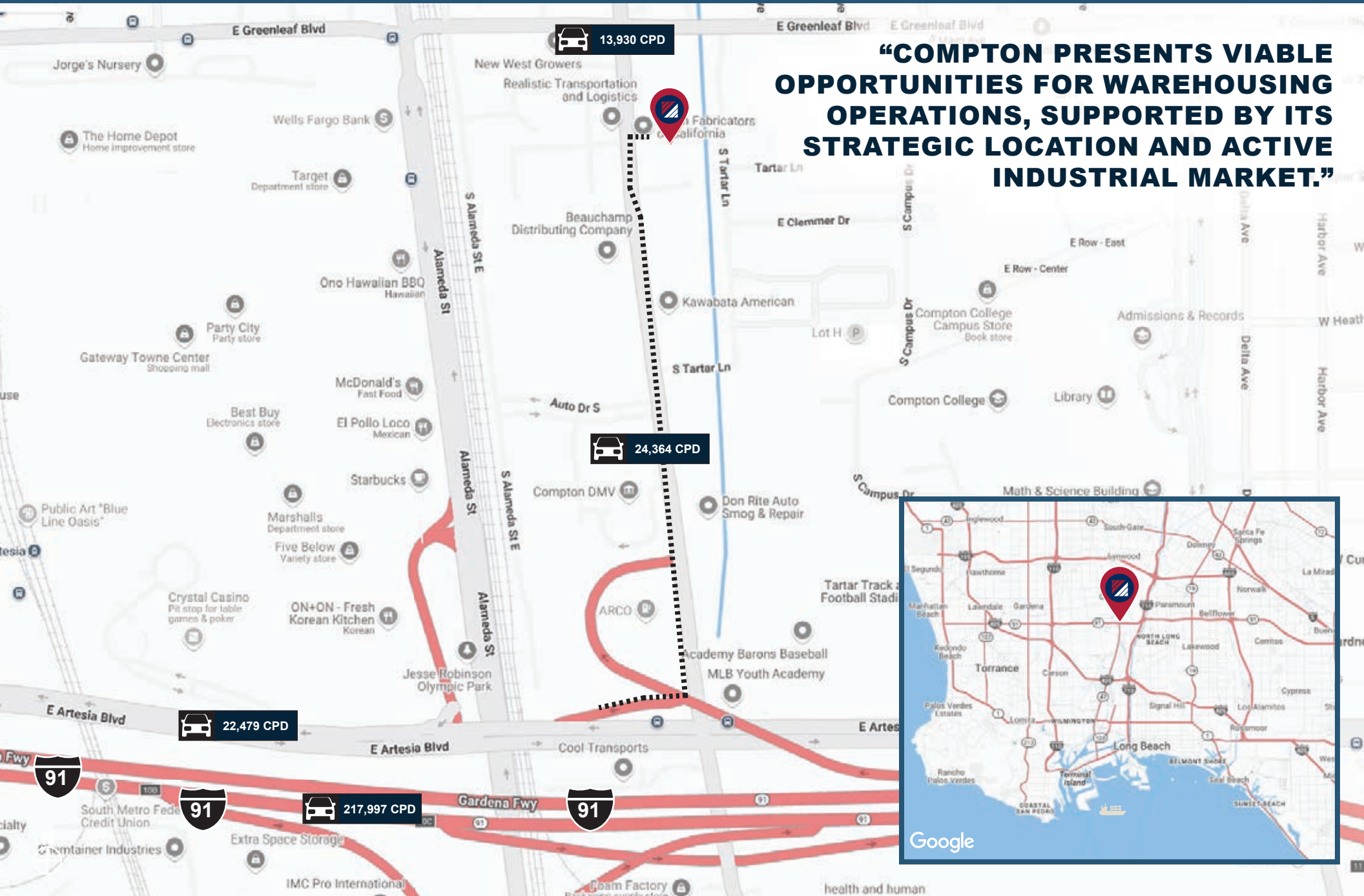

LOCATION



**EXCELLENT
ACCESS
TO MAJOR
FREEWAYS 91,
710, 110, AND 405**



**17 MILES FROM
DOWNTOWN
LOS ANGELES**



**LONG BEACH AIRPORT
13 MIN | 7.7 MI
LOS ANGELES
INTERNATIONAL AIRPORT
23 MIN | 15.6 MI**



**ARTESIA STATION (BLUE LINE - LOS
ANGELES COUNTY METROPOLITAN
TRANSPORTATION AUTHORITY
(METRO))
3 MIN | 17 MIN | 0.8 MI**



S. SANTA FE AVE.

COMPTON 1810 S. CALIFORNIA
Santa Fe Ave.

EXCLUSIVE LISTING AGENTS

DAVID FREITAG
P: 213.270.2235 | M: 310.413.9390
E: dfreitag@daumcre.com
CA License #00855673

BRIAN JORGE
D: 310.538.6702
E: bjorge@daumcre.com
CA License #01947601

JEFF JORGE
D: 310.538.6703
E: jjorge@daumcre.com
CA License #01947947

KRIS COONTZ
D: 213.270.2231 | M: 626.660.5514
E: kcoontz@daumcre.com
CA License #02216169

D/AQ Corp. #01129558. Maps Courtesy @Google & @Microsoft. Although all information is furnished regarding for sale, rental or financing is from sources deemed reliable, such information has not been verified and no express representation is made nor is any to be implied as to the accuracy thereof, and it is submitted subject to errors, omissions, changes of price, rental or other conditions, prior sale, lease or financing, or withdrawal without notice.