



PREPARED FOR

**CHARLES DUNN
REAL ESTATE**

PROJECT TYPE

FLOOR PLAN

PROJECT NAME

2279 E. 49TH ST.

PROJECT ADDRESS

**2279 E. 49TH ST.
VERNON, CA 90058**

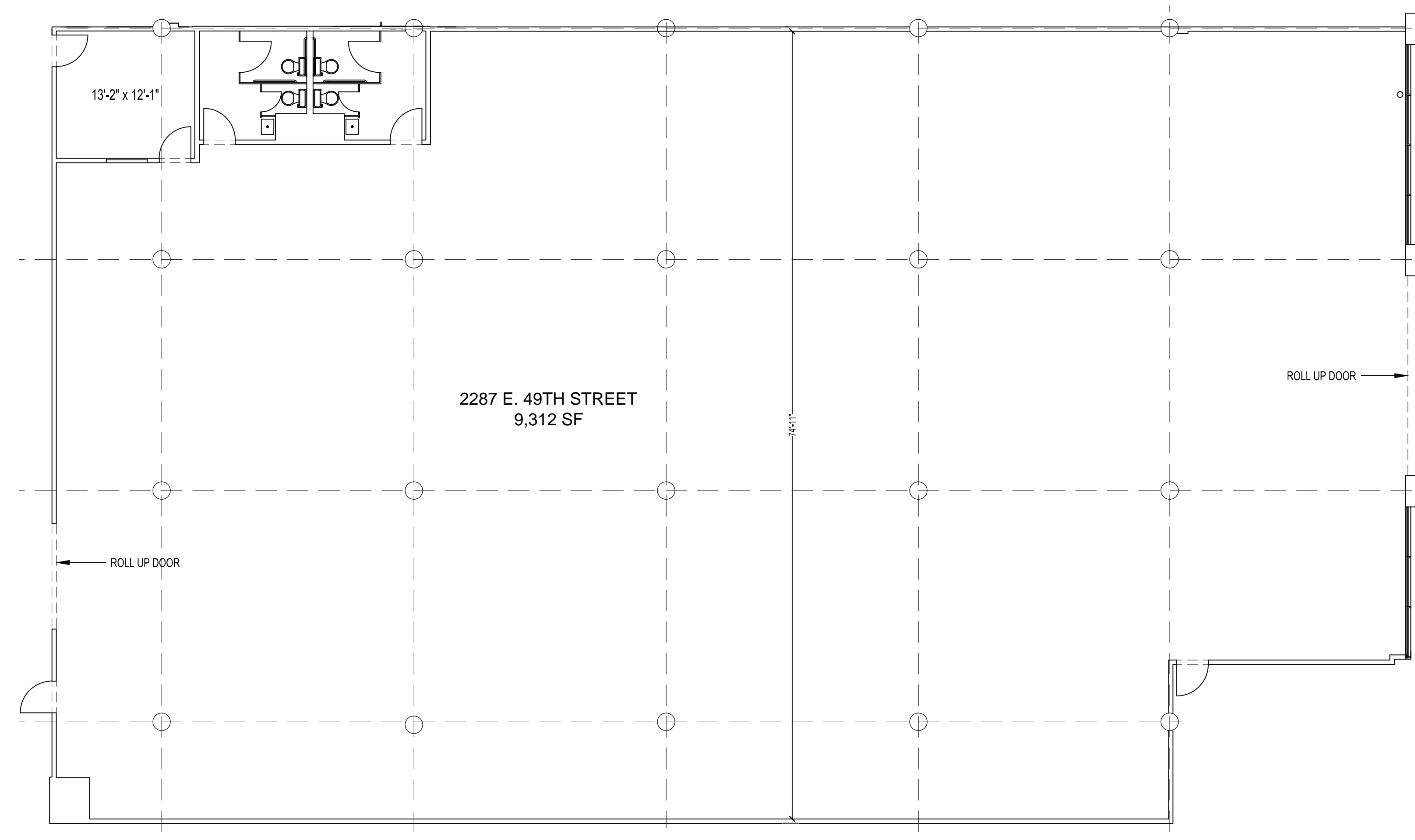

All plans created by Precision Property Measurements Ltd (PPM) are made exclusively for landscaping purposes (Cal. Bus. & Prof. Code 86727). All plans created by PPM do not involve the determination of any property line, and as such do not constitute land surveys (Cal. Bus. & Prof. Code 86500-86727). In addition, PPM services and plans do not constitute civil engineering (Cal. Bus. & Prof. Code 86702-8704) and thus should not be used for any studies or activities defined as civil engineering (Cal. Bus. & Prof. Code 86203). PPM makes every reasonable effort to ensure the accuracy of the information found in our plans. In the event that our plans are used for reasons other than those for which they are specifically intended, PPM shall not be held liable for any damages or any claims arising out of such use. Furthermore, PPM shall not be held liable for any damages or any claims arising out of the use of our plans unless such damage or claim is caused by our negligence. Measurements should be field confirmed before commencing construction.

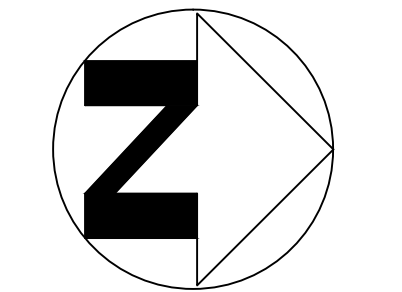

SCALE
 $\frac{1}{16}'' = 1'-0''$

PROJECT
10414

APPROVED BY
#33

DATE
12/29/14

SHEET
5 of 14

FIRST FLOOR

