



±29,932 SF WAREHOUSE FOR LEASE

3102 W. ADAMS STREET
SANTA ANA, CA

CONTACT EXCLUSIVE LISTING AGENTS:

DAVID FREITAG
EXECUTIVE V. P. | PRINCIPAL
P: 213.270.2235
dfreitag@daumcre.com
CA License #00855673

MIKE BARREIRO
EXECUTIVE V. P. | PRINCIPAL
P: 949.355.8500
mbarreiro@daumcre.com
CA BRE License #01712620



4
DOCK WELL



22'
CLEARANCE



LARGE
FENCED YARD



3,000 SF
OFFICE SPACE



D/AQ Corp. #01129558, Maps Courtesy ©Google & ©Microsoft. Although all information is furnished regarding for sale, rental or financing is from sources deemed reliable, such information has not been verified and no express representation is made nor is any to be implied as to the accuracy thereof, and it is submitted subject to errors, omissions, changes of price, rental or other conditions, prior sale, lease or financing, or withdrawal without notice.

BACK ON THE MARKET!

29,932 SF
WAREHOUSE

3102 W. ADAMS STREET
SANTA ANA, CA

FOR LEASE

W. ADAMS STREET



PROPERTY DESCRIPTION

3102 W. Adams St, Santa Ana is just completed extensive renovations, the property has outstanding features across the board, superb loading consisting of both ground level and exterior dock highs, excellent truck access and turning radius, 22 ft warehouse clear height, sprinklers and oversized fence lot. 3102 W. Adams St offers excellent utility whether for manufacturing, distribution or a corporate headquarters. The property is centrally located to I-405, I-55, I-73 & I-5, in the heart of the highly desirable Airport Area submarket of Orange County.

PROPERTY HIGHLIGHTS

- ± 29,932 SF
- 1.67 Acre Lot (72,745 SF Lot)
- ± 3,000 SF Office with HVAC
- Large Fenced Yard
- Manufacturing/Distribution Building
- Four (4) DH Loading Doors/Positions
- Two (2) Ground Level Loading Doors
- Four (4) Restrooms
- 100% Footprint
- 22' Clear Height
- Sprinklered
- 1,200 AMPS | 480 Voltage
- Highly Desirable Airport Area Submarket (3.8% Vacancy Rate)
- M-1 Zoning
- 45 Parking Spaces
- Asking Rate: \$0.89/SF NNN
- NNN Fees: \$0.11/SF



ABOUT
THE
PROPERTY

D/AQ Corp. #01129558. Maps Courtesy ©Google & ©Microsoft. Although all information is furnished regarding for sale, rental or financing is from sources deemed reliable, such information has not been verified and no express representation is made nor is any to be implied as to the accuracy thereof, and it is submitted subject to errors, omissions, changes of price, rental or other conditions, prior sale, lease or financing, or withdrawal without notice.

29,932 SF
WAREHOUSE

3102 W. ADAMS STREET
SANTA ANA, CA

FOR LEASE



DAUM
COMMERCIAL REAL ESTATE SERVICES



ABOUT
THE
PROPERTY

D/AQ Corp. #01129558. Maps Courtesy ©Google & ©Microsoft. Although all information is furnished regarding for sale, rental or financing is from sources deemed reliable, such information has not been verified and no express representation is made nor is any to be implied as to the accuracy thereof, and it is submitted subject to errors, omissions, changes of price, rental or other conditions, prior sale, lease or financing, or withdrawal without notice.

29,932 SF
WAREHOUSE

PROPERTY FLOOR PLAN

3102 W. ADAMS STREET
SANTA ANA, CA

FOR LEASE

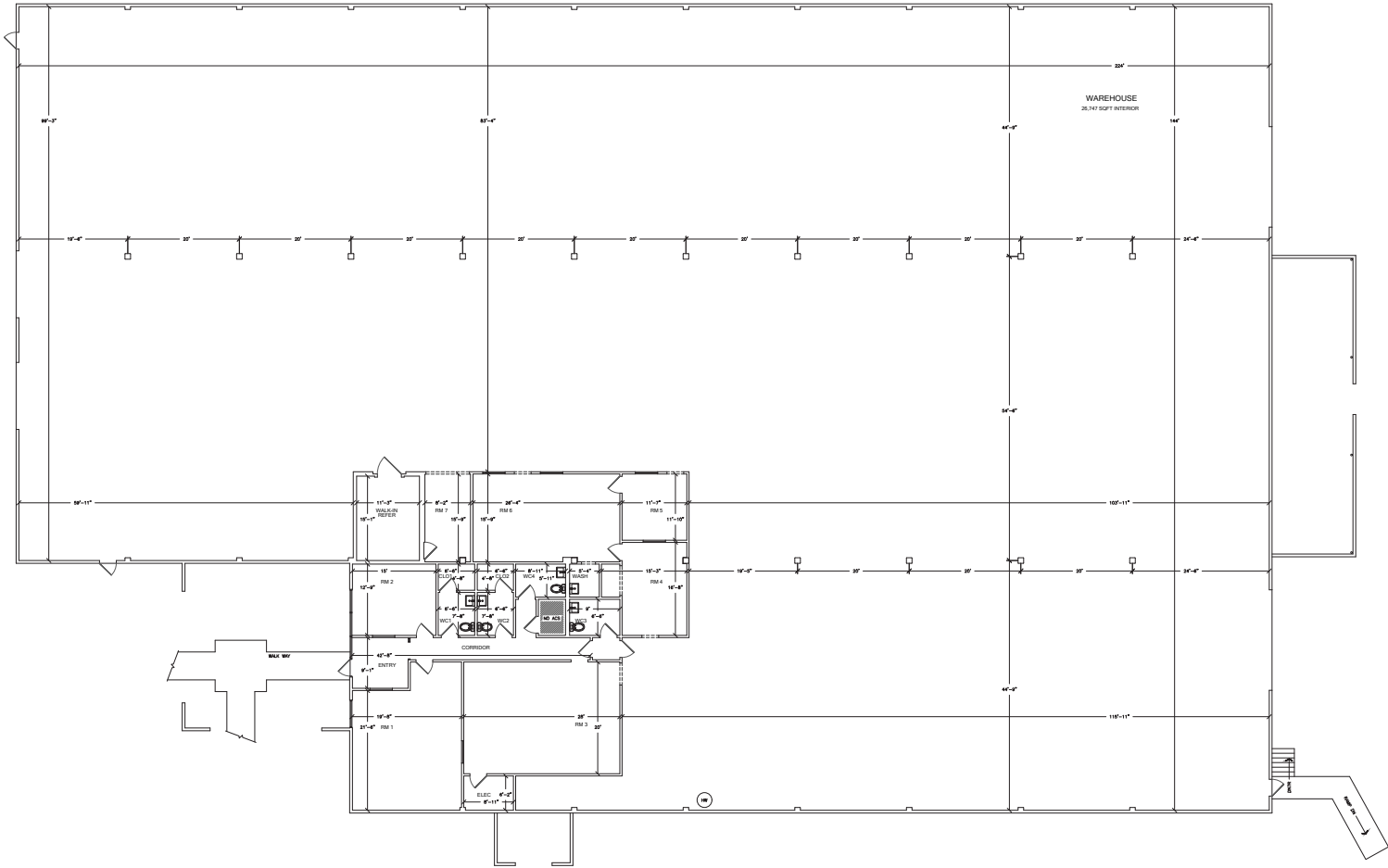

CONTACT EXCLUSIVE LISTING AGENTS:

DAVID FREITAG

EXECUTIVE VICE PRESIDENT | PRINCIPAL
P: 213.270.2235 | E: dfreitag@daumcre.com
CA License #00855673

MIKE BARREIRO

EXECUTIVE VICE PRESIDENT | PRINCIPAL
P: 949.355.8500 | E: mbarreiro@daumcre.com
CA BRE License #01712620

DAUM
COMMERCIAL REAL ESTATE SERVICES

D/AQ Corp. #01129558. Maps Courtesy @Google & @Microsoft. Although all information is furnished regarding for sale, rental or financing is from sources deemed reliable, such information has not been verified and no express representation is made nor is any to be implied as to the accuracy thereof, and it is submitted subject to errors, omissions, changes of price, rental or other conditions, prior sale, lease or financing, or withdrawal without notice.

29,932 SF
WAREHOUSE

FOR LEASE
3102 W. ADAMS STREET
SANTA ANA, CA



Google

CONTACT EXCLUSIVE LISTING AGENTS:

DAVID FREITAG

EXECUTIVE VICE PRESIDENT | PRINCIPAL
P: 213.270.2235 | E: dfreitag@daumcre.com
CA License #00855673

MIKE BARREIRO

EXECUTIVE VICE PRESIDENT | PRINCIPAL
P: 949.355.8500 | E: mbarreiro@daumcre.com
CA BRE License #01712620

DAUM
COMMERCIAL REAL ESTATE SERVICES

D/AQ Corp. #01129558. Maps Courtesy @Google & @Microsoft. Although all information is furnished regarding for sale, rental or financing is from sources deemed reliable, such information has not been verified and no express representation is made nor is any to be implied as to the accuracy thereof, and it is submitted subject to errors, omissions, changes of price, rental or other conditions, prior sale, lease or financing, or withdrawal without notice.

**29,932 SF
WAREHOUSE**

**3102 W. ADAMS STREET
SANTA ANA, CA**

FOR LEASE

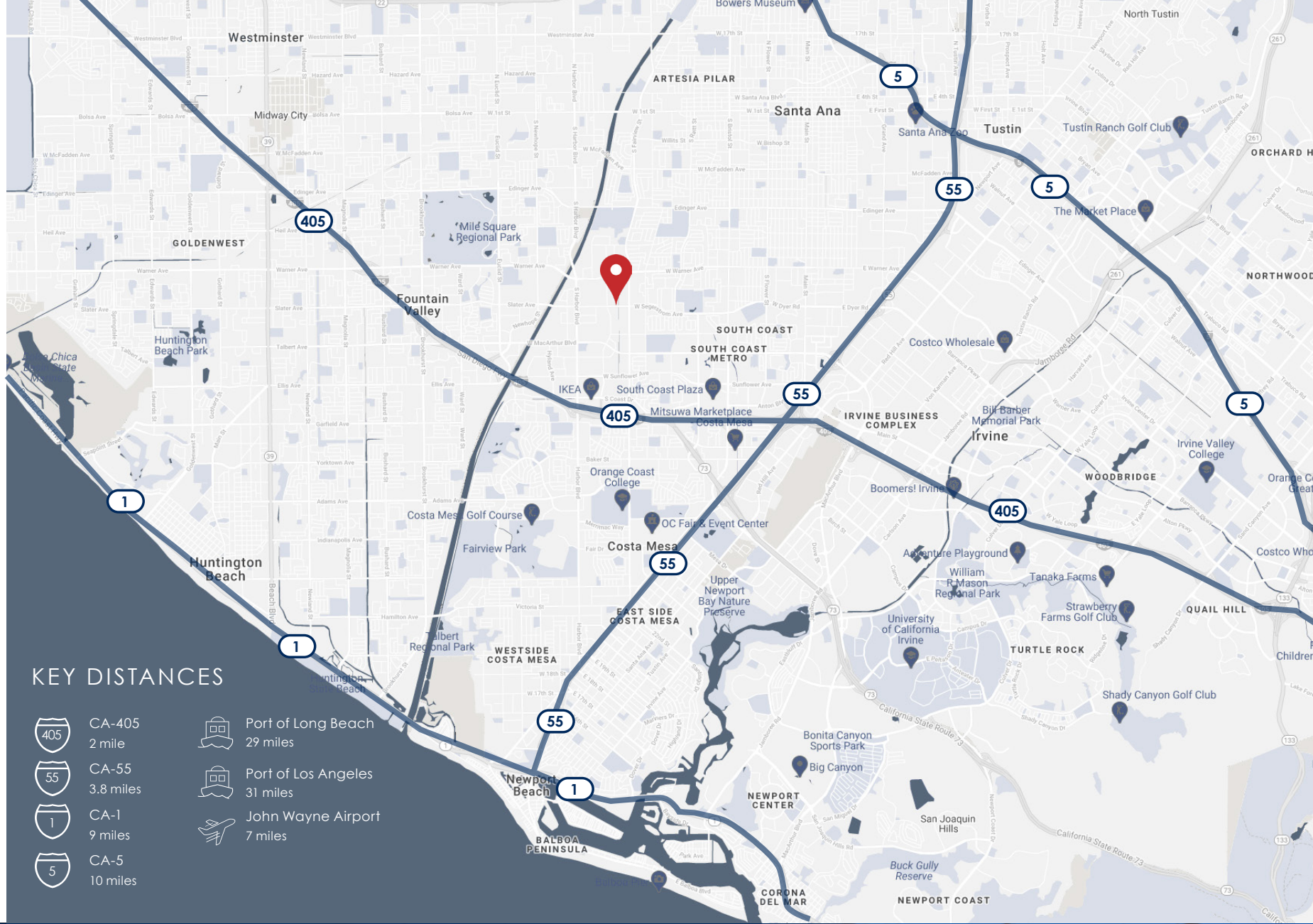

KEY DISTANCES

-  CA-405
2 mile
-  CA-55
3.8 miles
-  CA-1
9 miles
-  CA-5
10 miles
-  Port of Long Beach
29 miles
-  Port of Los Angeles
31 miles
-  John Wayne Airport
7 miles

CONTACT EXCLUSIVE LISTING AGENTS:

DAVID FREITAG
EXECUTIVE VICE PRESIDENT | PRINCIPAL
P: 213.270.2235 | E: dfreitag@daumcre.com
CA License #00855673

MIKE BARREIRO
EXECUTIVE VICE PRESIDENT | PRINCIPAL
P: 949.355.8500 | E: mbarreiro@daumcre.com
CA BRE License #01712620



D/AQ Corp. #01129558. Maps Courtesy @Google & @Microsoft. Although all information is furnished regarding for sale, rental or financing is from sources deemed reliable, such information has not been verified and no express representation is made nor is any to be implied as to the accuracy thereof, and it is submitted subject to errors, omissions, changes of price, rental or other conditions, prior sale, lease or financing, or withdrawal without notice.