

# FOR LEASE

CREATIVE OFFICE, SHOWROOM, AND WAREHOUSE

# 6100

W. JEFFERSON BLVD.

# 5100

CULVER CITY | CA



For More Information, Contact:

**DAVID FREITAG**

P: 213.270.2235

dfreitag@daumcre.com

CA License #00855673

**IMANI MCMILLAN**

P: 213.270.2230

imcmillan@daumcre.com

CA License #02057115

**DAUM**  
COMMERCIAL REAL ESTATE SERVICES

FREESTANDING BUILD

# B100

W. JEFFERSON BLVD.

CULVER CITY | CA

## PROPERTY HIGHLIGHTS

- Available November 1st, 2021
- 10,000 sq. ft.
- Space can be Divisible Into 4,000 or 6,000 sq. ft.
- Three (3) Ground Level Doors
- Freestanding Building
- Natural Light
- Fully Air Conditioned
- Private Breakout Rooms
- Open Kitchen and Conference Rooms
- Gated Parking Lot – 15 Cars at no Charge
- \$2.95 per sq. ft. Modified Gross

### FOR MORE INFORMATION, CONTACT:

#### DAVID FREITAG

P: 213.270.2235 | M: 310.413.9390  
dfreitag@daumcre.com  
CA License #00855673

#### IMANI MCMILLAN

P: 213.270.2230 | M: 310.800.4589  
imcmillan@daumcre.com  
CA License #02057115

Although all information is furnished regarding for sale, rental or financing is from sources deemed reliable, such information has not been verified and no express representation is made nor is any to be implied as to the accuracy thereof, and it is submitted subject to errors, omissions, changes of price, rental or other conditions, prior sale, lease or financing, or withdrawal without notice. D/AQ Corp. # 01129558

W. JEFFERSON BLVD.

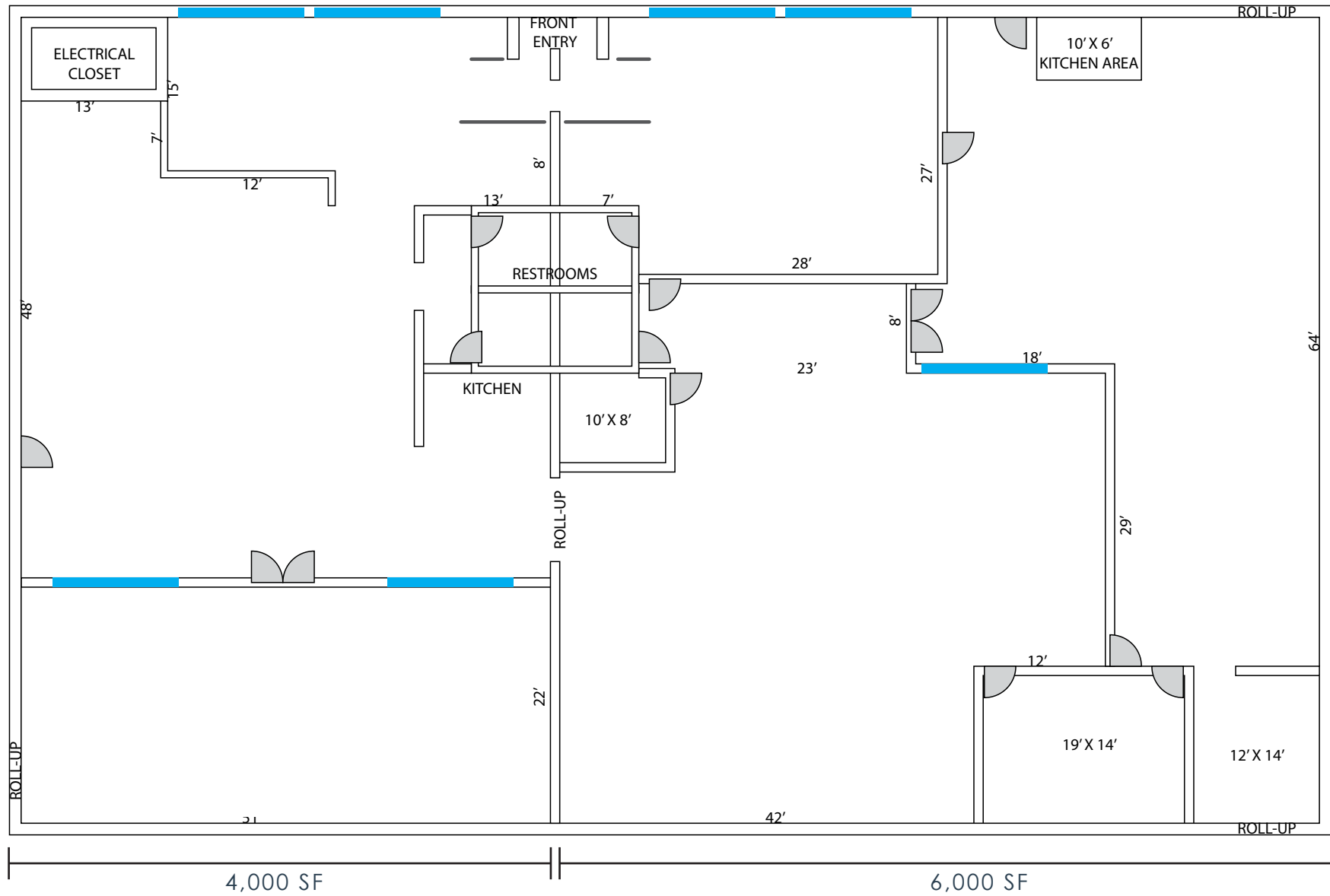

4,000 SF

6,000 SF

**SITEPLAN**

FREE STADNING BUILDING | CREATIVE OFFICE, SHOWROOM, AND WAREHOUSE | FOR LEASE







**PHOTOS**

FREE STADNING BUILDING | CREATIVE OFFICE, SHOWROOM, AND WAREHOUSE | FOR LEASE





**PHOTOS**

FREE STADNING BUILDING | CREATIVE OFFICE, SHOWROOM, AND WAREHOUSE | FOR LEASE



CULVER CITY

DOWNTOWN LA



SUBJECT PROPERTY

5190

AERIAL

FREE STADNING BUILDING | CREATIVE OFFICE, SHOWROOM, AND WAREHOUSE | FOR LEASE



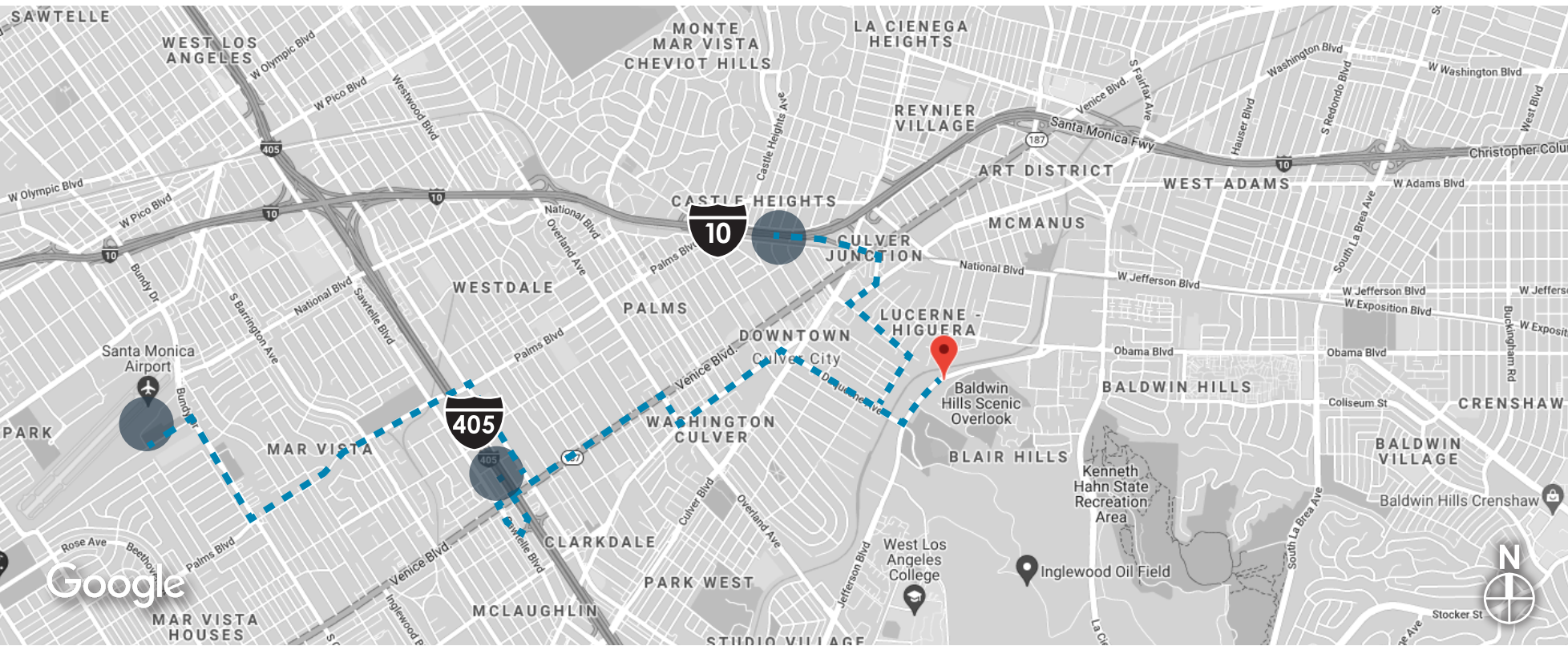

**LOCATION**

FREE STADNING BUILDING | CREATIVE OFFICE, SHOWROOM, AND WAREHOUSE | FOR LEASE

**DEMOGRAPHICS**

SOURCE: COSTAR\*

**POPULATION 2021**

**+885,524**  
PEOPLE  
(5 MILE RADIUS)

**+366,459**  
HOUSEHOLDS  
(5 MILE RADIUS)

**\$111,465**  
AVERAGE HH INCOME  
(5 MILE RADIUS)

**ECONOMICS**

**\$13,579,686,293**  
CONSUMER SPENDING  
(5 MILE RADIUS) | 2026



**\$12,449,583,339**  
CONSUMER SPENDING  
(5 MILE RADIUS) | 2021

**TRAFFIC COUNT**

**8,549**  
EASTHAM DR W.  
(0.40 MILES FROM PROPERTY - 2020)



**24,927**  
RODEO DR. NO.  
(0.41 MILES FROM PROPERTY - 2020)

**27,922**  
W JEFFERSON BLVD W.  
(0.53 MILES FROM PROPERTY - 2020)

**30,727**  
KALSMAN DR E.  
(0.58 MILES FROM PROPERTY - 2020)

FOR MORE INFORMATION, CONTACT:

**DAVID FREITAG**

P: 213.270.2235 | M: 310.413.9390  
dfreitag@daumcre.com  
CA License #00855673

**IMANI MCMILLAN**

P: 213.270.2230 | M: 310.800.4589  
imcmillan@daumcre.com  
CA License #02057115

