

NOW READY FOR OCCUPANCY

FOR LEASE 60,000 SF

PLEASANT VALLEY RD. | CAMARILLO | CA

2385

REFURBISHMENT COMPLETE



**MITCHELL CONLEE**

Executive Vice President  
P: 805.384.8815 | M: 805.443.3346  
mconlee@daumcommercial.com  
CA License # 00912213

**DAVID FREITAG**

Executive Vice President  
P: 213.270.2235 | M: 310.413.9390  
dfreitag@daumcommercial.com  
CA License #00855673



# FOR LEASE 60,000 SF

PLEASANT VALLEY RD. | CAMARILLO | CA



## PROPERTY HIGHLIGHTS

- Now Ready for Occupancy
- Refurbishment Complete
- Corporate Manufacturing R.D. Warehouse Facility
- 60,000 SF Available
- 15,000 SF of Above-Standard Office Space
- 132,858 SF Land
- Extensive Electrical Distribution
- Nicely Improved Glass Lined Offices
- Excellent Location with Corporate Identity
- Close Proximity to 101 Freeway

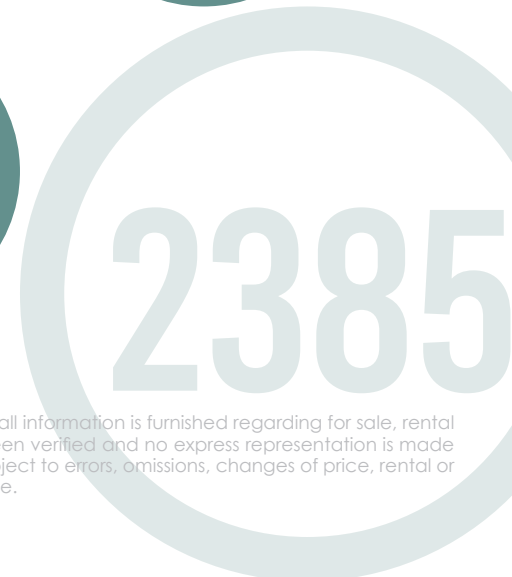
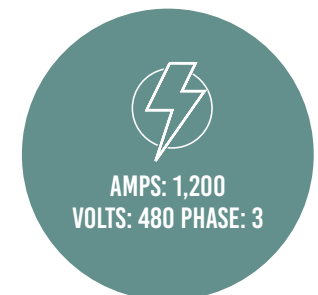

D/AQ Corp. #01129558. Maps Courtesy @Google & @Microsoft. Although all information is furnished regarding for sale, rental or financing is from sources deemed reliable, such information has not been verified and no express representation is made nor is any to be implied as to the accuracy thereof, and it is submitted subject to errors, omissions, changes of price, rental or other conditions, prior sale, lease or financing, or withdrawal without notice.

# SITE PLAN

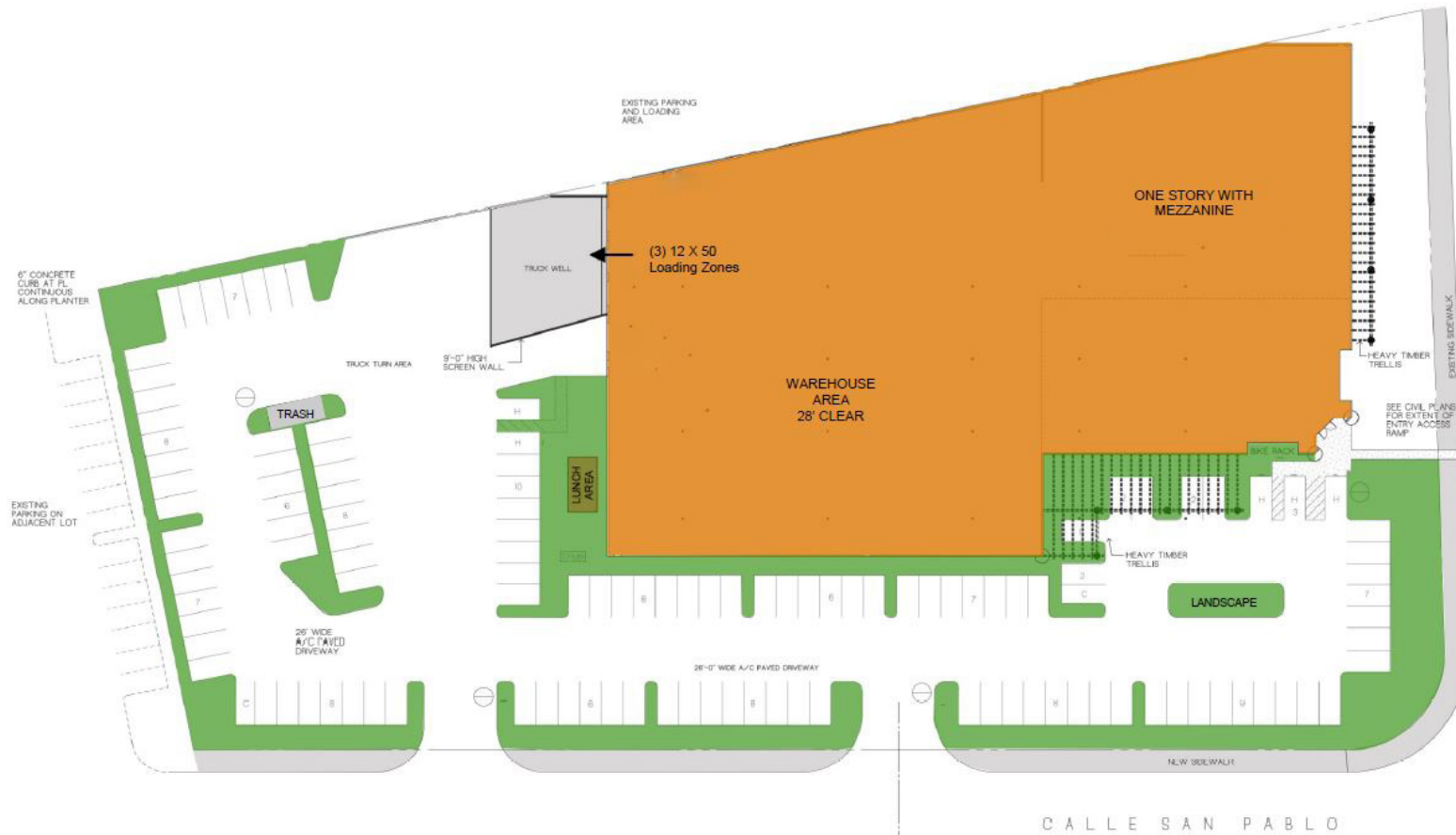

2385

FOR LEASE 60,000 SF  
PLEASANT VALLEY RD. | CAMARILLO | CA

**DAUM**  
COMMERCIAL REAL ESTATE SERVICES

# EXTERIOR PHOTOS



2385

FOR LEASE 60,000 SF  
PLEASANT VALLEY RD. | CAMARILLO | CA

**DAUM**  
COMMERCIAL REAL ESTATE SERVICES

# INTERIOR PHOTOS

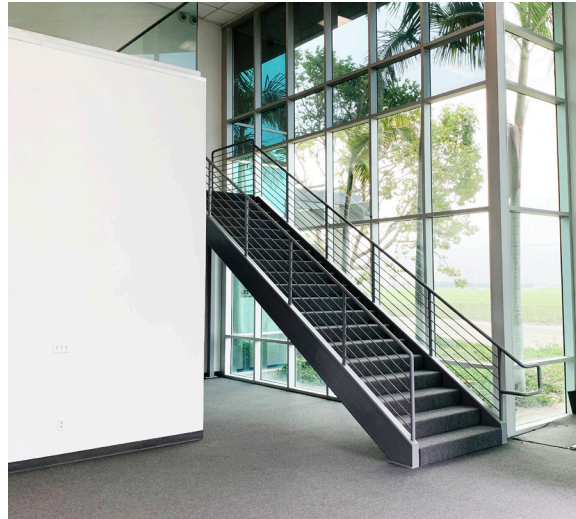

2385

FOR LEASE 60,000 SF  
PLEASANT VALLEY RD. | CAMARILLO | CA

**DAUM**  
COMMERCIAL REAL ESTATE SERVICES

# AERIAL & LOCATION MAP

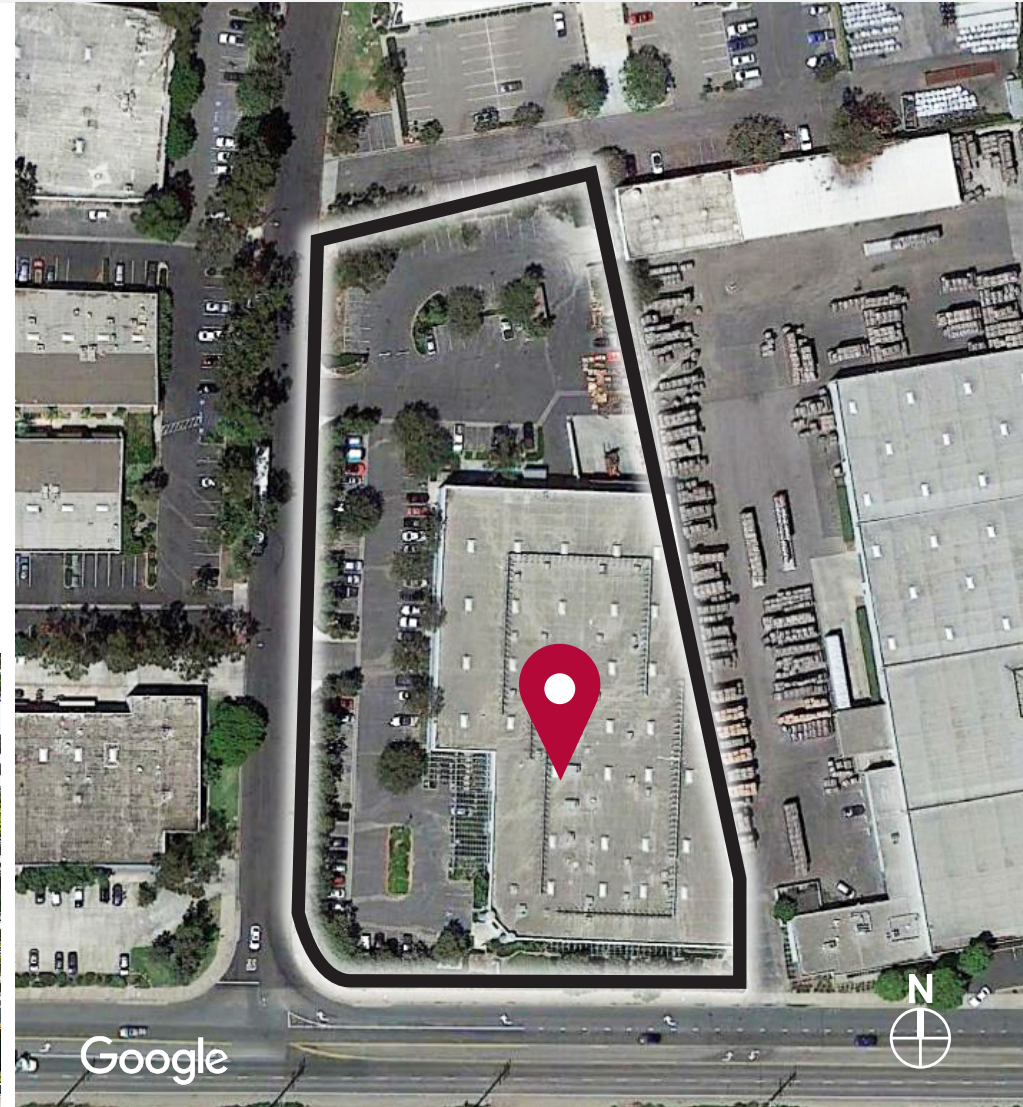
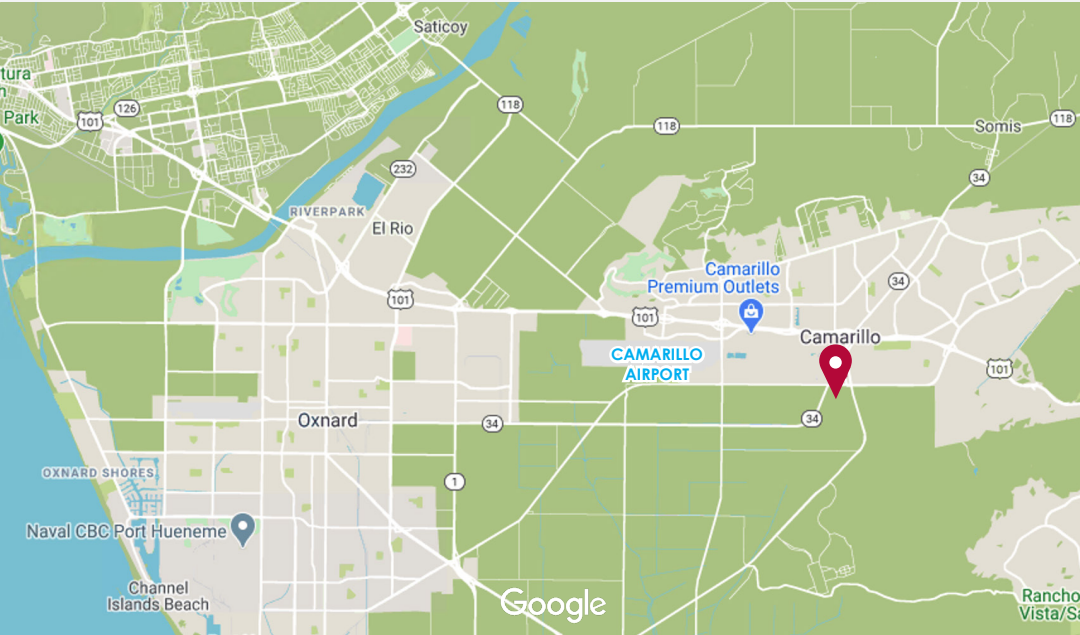

2385

FOR LEASE 60,000 SF  
PLEASANT VALLEY RD. | CAMARILLO | CA

**DAUM**  
COMMERCIAL REAL ESTATE SERVICES